



# SUMMIT AGENDA

**7:30 AM Registration and Breakfast** McKinley

**8:00 AM STEM in Action Excursion Orientation** McKinley  
Caroline King, Washington STEM

**8:20 AM BOARD BUSES**

**8:30 AM STEM in Action Excursions**

- Career Connected Learning Pathways
- Computer Science
- Hacking STEM & Minecraft at Microsoft
- Lake Washington Institute of Technology
- StoryTime STEM
- Mercer Slough Environmental Education Center

**11:00 AM LUNCH BUFFET**

**11:30 AM Welcome**  
Mary Snapp, Microsoft Philanthropies

**State of STEM**  
Caroline King, Washington STEM

**Youth Panel**  
Mahilat Abraha, Shorewood High School  
Kamaria Lyles, Summit Sierra High School  
Citlaly Ramirez, Western Washington University  
Yasmin Yazsaid, North Seattle College

**“We the People”: National Citizenship and the Reach of the Preamble**  
Keynote Speaker Bob Moses

**1:00 PM BREAK**

**1:15 PM Breakout Sessions** Hood

- Engaging Families, Educators, and Institutions to Enhance Early Math Learning - The road to advanced STEM education and careers starts with early mathematics. Unfortunately, more than half of Washington students arrive at kindergarten without essential mathematics skills. Come learn about the innovative work

that state agencies, researchers, and local innovators are doing to make sure every child is a mathematician and every adult is a champion for math learning.

• **Authentic Employer and Education Engagement in Career Connected Learning** - Join educators and STEM professionals for a deep dive into career connected learning resources and programs that leverage employer assets to meet the needs of school systems and students in STEM. **St. Helens**

• **Advancing Equity and Diversity Through Next Generation Science and Engineering** - Come learn about innovative programs in our state that drive equitable access to high-quality STEM education. Be prepared to engage with other attendees and the presenters in conversation and ideation. **Rainier**

• **Innovations in Inclusive Computer Science Education** - The CS for All movement requires innovative approaches to the delivery of computer science education. Come network with leaders across the K-12 spectrum as they share equity-based strategies and resources. **Baker**

**2:30 PM BREAK**

**2:45 PM Closing Comments** **Kodiak Auditorium**  
Caroline King, Washington STEM  
Mike Delaney, The Boeing Company  
Susan Mullaney, Kaiser Permanente

**Equity Conversation**  
Monet Becenti, First Nations MESA  
Dr. Kristin Conn, Kaiser Permanente  
Dr. Sheila Edwards Lange, Seattle Central College  
Mandy Manning, Washington Teacher of the Year

**Wrap Up**

**3:45 PM CLOSING RECEPTION**

**MICROSOFT WIFI ACCESS:**  
MSFTOPEN  
msevent44kt

**EVENT APP:**  
<https://washingtonstemsummit2017.sched.com>

**#waSTEMsummit**

**[www.washingtonstem.org](http://www.washingtonstem.org)**

EVENT MAP

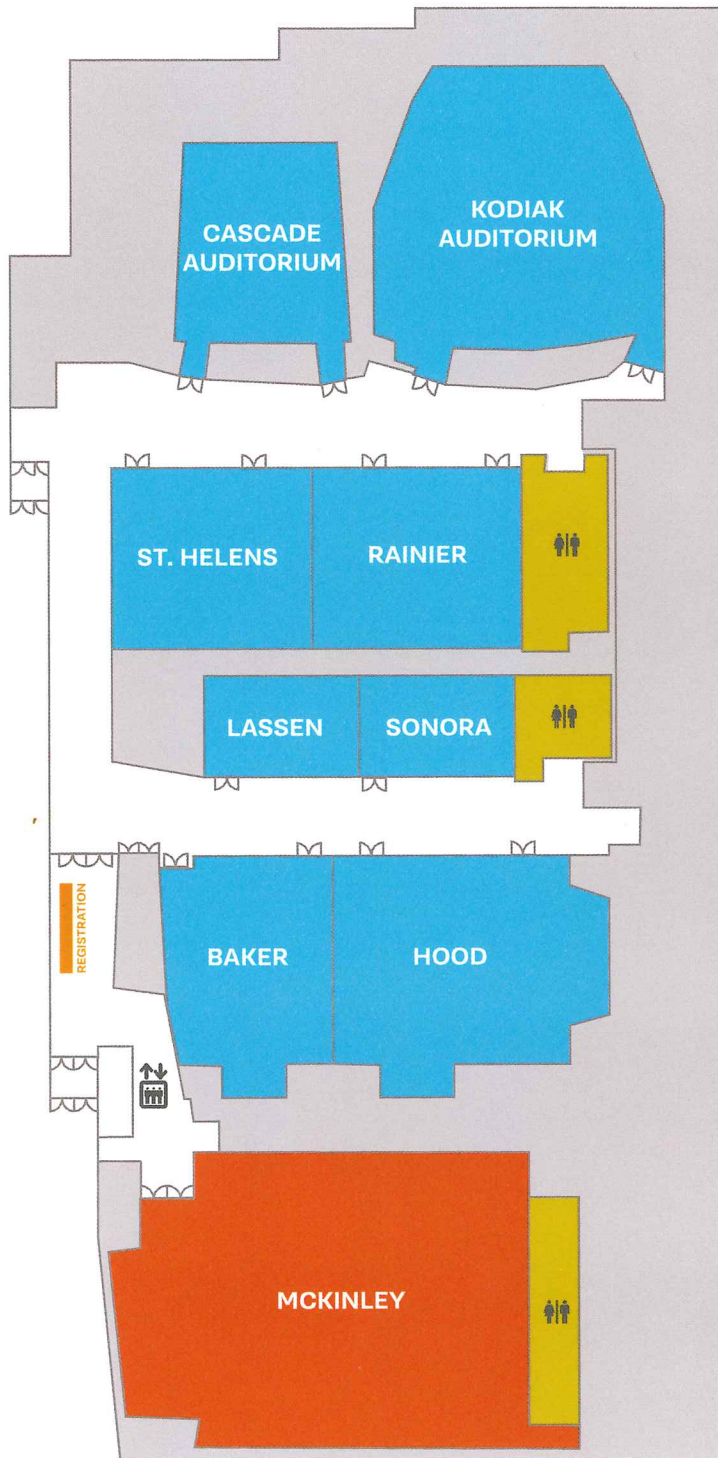

# THANK YOU TO OUR SPONSORS

PRESENTING



PLATINUM



BENEFACTOR



CONTRIBUTING

eBay | PEMCO | Servco Pacific Insurance | Siemens

# WASHINGTON STEM SUMMIT

NOVEMBER 28, 2017  
MICROSOFT CONFERENCE CENTER

